

# Advice to Cyclists

## New cycle route Horace Street to O'Connell Terrace, Bowen Hills

On 26 August 2006 Campbell Street in Bowen Hills was closed to the general public between Wren Street and Tufton Street to enable construction of the North-South Bypass Tunnel (NSBT). Horace Street between Campbell Street and the Inner City Bypass has also been closed.

**An alternate cycle route has been developed to provide access for cyclists between Horace Street and O'Connell Terrace.**

Cyclists are able to access the new cycle route via Lutwyche Road, then Horace Street, along the new cycle path to O'Connell Terrace and then join the existing shared pedestrian and cycle path.

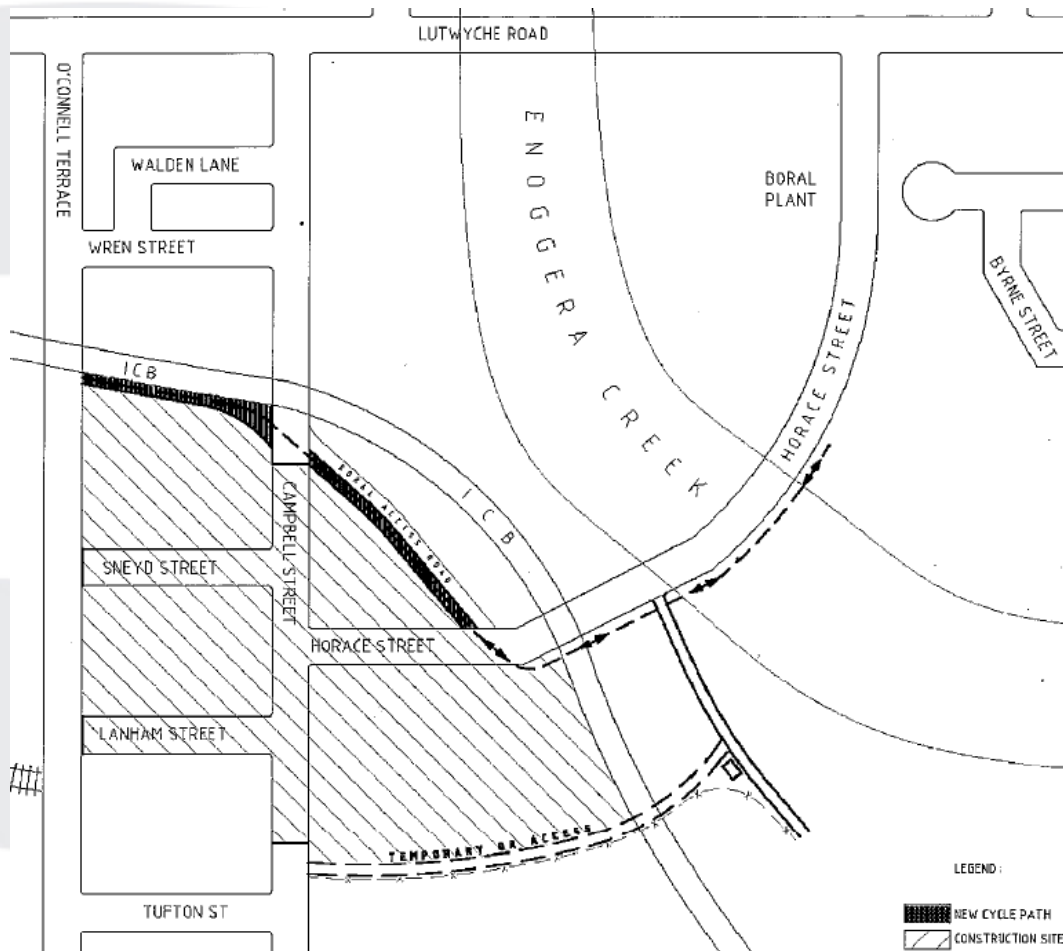

### Keep Informed

**Call the Team** - Our community relations team will answer any queries you may have and work with you throughout construction to minimise impacts wherever possible. You can contact the team at any time on (free call) **1800 22 36 37** or visit **[www.rivercitymotorway.net.au](http://www.rivercitymotorway.net.au)**

**We appreciate your patience during these important works and apologise for any inconvenience.**